

Instruction Manual

Air-hydraulic jack, A28-HC G1, A3216-C, A4020-C G1,
A4422-C G6, A5816-C G1, A5830-C G1

Important: Read and understand this manual before use!

WARNINGS - SAFE USAGE INSTRUCTIONS:

- This jack is only a lifting device.
- Do not move or dolly the load while on the jack.
- The load must be supported immediately by other appropriate means.
- Do not overload. Overloading can cause damage to or failure of the jack.
- Lift only on areas as specified by the vehicle manufacturer.
- Do not use more than the 3 standard extensions in sequence.
- This jack is designed for use only on hard level surfaces capable of sustaining the load. Use on other than hard level surfaces can result in jack instability, damage and possible loss of load.
- It is recommended that wheels on vehicles must be aligned.
- The vehicle must NOT be braked when lifting. This is to ensure a straight / vertical lift, and to prevent the load to move, and thereby damage the jack.
- No person should be located in, on, or under a load that is being jacked or is supported only by a jack.
- The factory set and sealed safety valve settings must not be changed.
- Maximum permissible pressure: 12 bar (170 PSI).
- Disregarding these warnings may cause the load to fall down, damaging the jack, and result in personal injury, property damage or even death.
- The jack must be inspected regularly, at least once a year by a qualified person.

Preparation of the jack:

Please note that it is necessary to use a little oil for lubrication during assembly of the jack. During transport this oil may drip to the bottom of the carton. This is inevitable and not a sign of defect. Unpack the jack and inspect for any damage. Oil the mechanical parts before starting up - and regularly thereafter.

! IMPORTANT: When the jack has been turned over or upside-down, a little oil will come into the hoses and come out with the pump exhaust. This is not a sign of defect and will stop after operating the jack for some time. Wipe away any excess oil.

Connect the air hose. (min. 8 bar - max. 12 bar). Maximum lifting capacity is achieved at 10-12 bar.

! IMPORTANT: The air supply **MUST** be fitted with oil lubrication and water separator.

Use of the jack:

Adjustable handle:

The handle can be placed in three different positions by pulling the lever and moving the handle.

Lifting a load:

The operating valve on the top of the handle should be turned slowly to the right, the pump is activated and the jack lifts.

Lowering the load:

The operating valve on the top of the handle should be turned slowly to the left, and the jack lowers.

After use always return the lifting cylinder to its lowest position to protect the cylinder.

IMPORTANT: Always place the handle in the horizontal position before lowering.

There is a risk that the handle/chassis will be damaged, if a vehicle is lowered onto the handle, while the handle is not in the horizontal position.

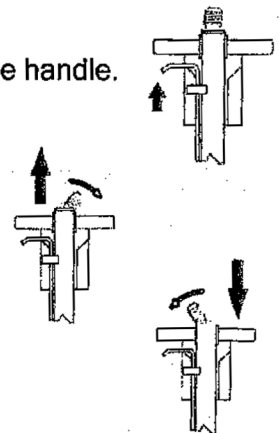

Handling of the jack:

The most common reason for oil entering the air system is caused by wrong handling.

These types of jacks may **ONLY** be lifted and transported, in upright position (See Fig. 1).

Failing to keep the jack in an **upright position**, may cause hydraulic oil to enter the air system.

Do **NOT** place the jack on its side. (Not even under transporting) (See Fig. 2).

Do **NOT** turn the jack upside down. (Not even when lifting the jack) (See Fig. 2).

Failing to follow the above instructions may cause hydraulic oil to enter the air system.

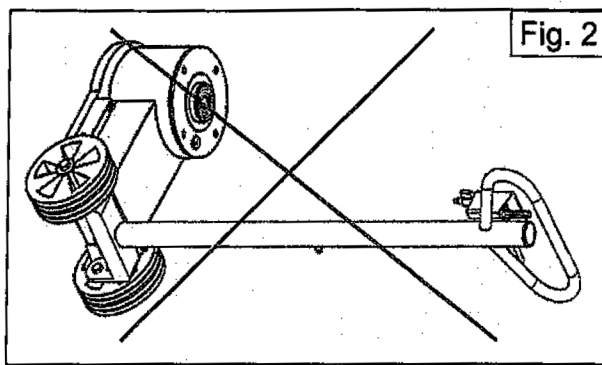
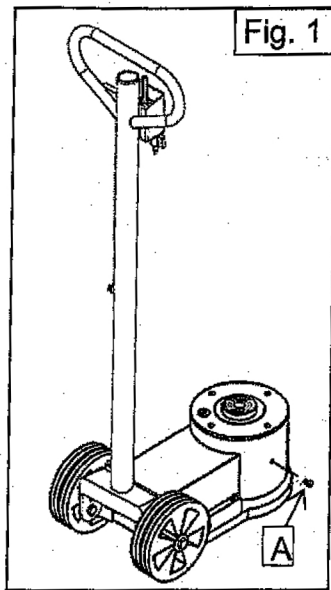

Maintenance:

IMPORTANT: Like other pneumatic tools the air pump of the jack needs oil for lubricating the moving parts. It is important to use a built-in air lubricator and water separator (filter) on the air supply nearby the air connection on the Jack. Moisture and water may damage the jack even after a short time.

I USE ONLY ONE OF THE FOLLOWING TYPES OF OIL IN THE AIR LUBRICATOR: AGIP OSO 100, MOBIL DTE 27, ESSO TERESSO100, SHELL TELLUS 100, BP ENERGOL HP 100.

Weekly:

Lubricate the air motor by injecting a little oil into the air connection. Lubricate the cylinder wall and spread the oil by lifting to maximum position.

Monthly:

Lubricate all moving parts with a few drops of oil. At the same time inspect the jack and extensions for damage and wear and tear.

Oil level:

Important! Too high oil level can cause oil leakage.

Do not fill on too much oil on this jack, it is important that the oil level is correct.

Always check the oil level, with the jack in horizontal position, and with the lifting Piston in lowered position.

Correct oil level is when the oil reaches the lower edge of the hole.

Any excessive oil must be drained, by unscrewing oil plug [A], placed on the side of the oil tank (See Fig. 1) and letting all excessive oil run out of the drain hole, When no more oil is coming out of the drain hole, screw on the oil plug again, and the oil level is now correct.

Oil specification:

Castrol ATF DEX II or similar oil with same specifications can be used.

I NEVER USE BRAKE FLUID!

Possible faults and how to solve them:

1. Oil has entered the air system:

The most common reason for oil entering the air system is caused by wrong handling or too high oil level.

Oil leaks caused by wrong handling require **NO** repair.

Has any oil entered the air system, it will come out through the silencer / filter of the air pump, in form of an oil mist. If above rules are respected (See Warnings + Oil level), you don't need to do any more, the oil from air system will come out by itself and the abnormal oil mist will slowly decrease until finally have stopped.

2. The jack cannot lift to maximum height, and the pump runs continuously:

Check oil level and refill the oil tank if necessary.

3. The air pump operates slowly:

The air pump has not been lubricated enough, there is a problem with the air delivery. Check if there is oil in the air lubricator, check if the lubricator is functioning correctly. Check the air pressure, check if the air system is blocked.

4. The control valve cannot be moved or goes very slowly, even with pressure on the system:

The air supply is might be very watery and the lubricating film inside the valve has been washed away. Inspect the water separator and lubricator on the air supply. Loosen the fitting on the operating valve and fill the valve with oil. Operate the valve many times without air connected. Oil the jack more frequently.

5. In frosty weather: The jack will not pump:

There is too much water in the air supply, which has frozen. Mount a water separator with lubricator on the air supply. Change the oil of the jack, if there is water in it.

6. After extensive use, errors may occur because of worn seals:

Replace the old worn seals with new seals.

Destruction:

When the jack after several years is worn and must be dismantled, the oil must be drained off and legally disposed of.